



EzeeStat

Large LCD display
battery operated
programmable thermostat

USER GUIDE



Dimensions: 138 x 86 x 32 mm

Features:

- * Large LCD Display 72 x 64 mm.
- * Battery operated (2 x AA cells).
- * Interactive program settings.
- * EEPROM Memory backup.
- * Temperature Display Range 0°C ~ 50°C
- * Temperature Control Range 5°C ~ 35°C
- * Selectable 24 Hour/12 Hour Format.
- * 6 program periods (events) per day.
- * 5-2 day program. Weekday, Saturday, Sunday.
- * Switching Differential: 0.5°C-1.0°C user selectable
- * Max. **8Amp** switching current (1.7kW @ 230 Vac)

CONTENT

1. Choosing the best location for installation.
2. Opening and inserting the batteries.
3. Installation & wiring.
4. Startup Settings (C/F, Date & Time).
5. Programming the thermostat.
6. Using the override functions.
7. Erasing the backup memory (factory reset)
8. Replacing the batteries

CHOOSING THE BEST LOCATION

1

In order to get the best performance follow the advise given below.

- (1). Place thermostat on a wall inside the room to be heated at approximately 1.5 metres above the floor.
- (2). Avoid a position where the temperature sensing is not representative for the temperature in the room, such as areas exposed to direct sun light, near heat generating devices (refrigerator, tv, HiFi) or right next to a doorway or window.
- (3). Do not install the thermostat in a position where furniture or fixtures interfere with the air-flow. Install preferably on an open wall.
- (4). Keep the thermostat away from high humidity areas, as high humidity will reduce the thermostat's life span.
- (5). Before installing the thermostat, ensure that renovation activities are finished, e.g. no tacky paint / wet plaster right at the thermostat's installation position.
- (6). It is not necessary to accurately level the thermostat.

Opening and inserting the batteries

2

- (1). To open the housing, push a flat head screwdriver in the slot and lever upwards to open.

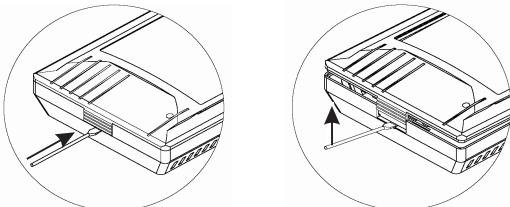

- (2). Install the batteries (2 x AA). Observe the polarity +/-!

INSTALLATION & WIRING

3

Unscrew to take safety cover off and wire as shown below:

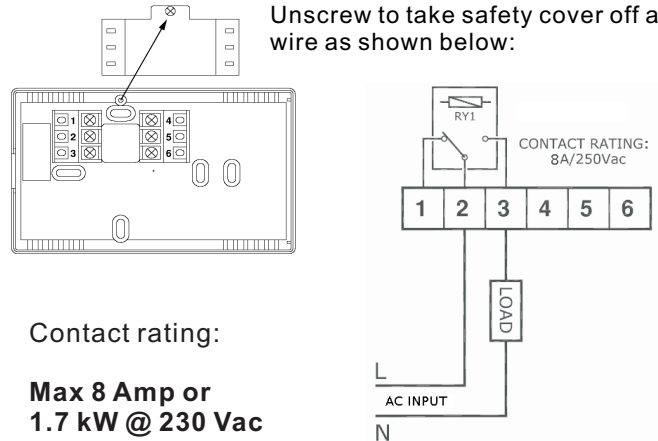

Contact rating:

**Max 8 Amp or
1.7 kW @ 230 Vac**

Replace the safety terminal and screw.

Note that this thermostat can be taken off the wall for programming. Remove the top part from the backing plate as explained under "2. Opening the thermostat".

STARTUP SETTINGS

4

Push button descriptions

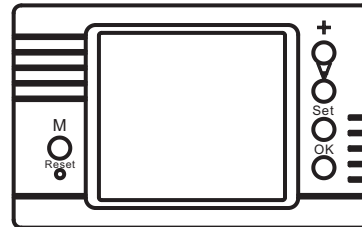

+/-: Up / Down keys.

Set: Programming Mode

OK: Confirm setting (enter)

M: Program override functions

Press 'SET' for 6 seconds to enter the startup settings. Follow the flashing guidance on the LCD to enter the following user settings:

1. **C/F** Use +/- to select Celsius or Fahrenheit - **OK** to enter.
2. **24H/12H** Use +/- to select 24 or 12 hour clock - **OK** to enter.
3. Using the same procedure set the date: **Year, Month, Day**.
4. Set the clock: **Hour, Minutes**.
5. Set the switching differential or hysteresis (0.5 °C or 1.0 °C)
6. **FILTER SERVICE INTERVAL**. This is a reminder timer only for air conditioning. Press **OK**.
7. Press **OK** again after the startup settings are completed.

PROGRAMMING

5

Whilst in programming mode, the thermostat will revert to 'run mode' if no buttons are pushed for 30 seconds!

FACTORY PRESET PROGRAM (INITIAL DEFAULT)

Mode 5+2d / P6 Factory Preset

Weekday	Time	Setpoint
MORN.(P1)	6:00	21.0 °C
DAY (P2)	8:30	15.5 °C
NOON (P3)	12:00 pm	21.0 °C
BREAK(P4)	2:00 pm	15.5 °C
EVEN. (P5)	4:30 pm	21.0 °C
NIGHT(P6)	10:30 pm	18.5 °C
Saturday	Time	Setpoint
MORN.(P1)	7:00	21.0 °C
DAY (P2)	8:30	21.0 °C
NOON (P3)	12:00 pm	21.0 °C
BREAK(P4)	2:00 pm	21.0 °C
EVEN. (P5)	4:30 pm	21.0 °C
NIGHT(P6)	10:30 pm	18.5 °C
Sunday	Time	Setpoint
MORN.(P1)	7:00	21.0 °C
DAY (P2)	8:30	21.0 °C
NOON (P3)	12:00 pm	21.0 °C
BREAK(P4)	2:00 pm	21.0 °C
EVEN. (P5)	4:30 pm	21.0 °C
NIGHT(P6)	10:30 pm	18.5 °C

NOTE:

In programming mode, if you want to stop programming the thermostat, either wait for 30 seconds, (let the thermostat automatically revert to run mode) or press the **SET** key twice and then press the **OK** key, to start the normal run mode.

Follow the guidance provided by the flashing display.

PROGRAMMING (5+2D)

For 5+2D Program (all 5 weekdays mon-fri) have the same program while Saturday & Sunday must be programmed separately)

1. Press the '**SET**' button to enter programming mode.
2. Press '+' or '-' to set the Temperature setpoint for the 1st program period(event) and press **OK**.
3. Now enter the start time for 1st program period using + or -, (Time & "Start Time" will be flashing). Press **OK**.
4. Enter the Temperature setpoint for 2nd program-period.
5. Repeat programming procedure above, to complete each of the temperature setpoints and starting times for every program period of the weekdays (Mon-Fri).
6. Repeat the programming procedure again to enter the temperature setpoints and starting times for Saturday & Sunday.
7. By pressing the "**SET**" key **twice** and then pressing "**OK**", the thermostat will start executing the program.

In Override setting mode, the thermostat will automatically revert back to normal operation if no buttons are pushed for 30 seconds.

Pressing the **M** button multiple times will cycle through the last three override modes as shown in the display.

Follow the guidance given by the flashing display.

6

PROGRAM OVERRIDE MODES

There are 4 override modes:

A. Temporary Override - Change the current setpoint until the next program period (event).

1. Press + or - to adjust the setpoint ("**Temp Set**" flashing)
2. Press '**OK**' or wait for 10 seconds. The thermostat will now run this temporary override function until the next event. (Display shows "**Temporary Override**")
Press **OK** again to cancel this override and return to normal run mode.

B. Comfort override - Change the current setpoint and hold the new setting for a number of hours.

1. Press '**M**' (Manual) once.
2. Press + or - to adjust the setpoint ("**Temp Set**" flashing).
3. Press **OK**.
4. Press + or - to set the duration of this override mode in hours (min. 1 hour).
5. Press **OK** to run in **Comfort Override Mode** (Count down timer is displayed instead of clock).
6. Pressing **OK** again will terminate this override mode.

C. Permanent Hold - Change the current setpoint and keep this new setting until canceled (by pressing **OK**).

1. Press '**M**' button twice to enter 'permanent hold temp' setting mode.
2. Press '+ or -' to adjust the setpoint (**Temp. Set** flashing)
3. Press **OK** to run in **Permanent Hold Temp.** mode.
4. Pressing **OK** will cancel / terminate this mode and the thermostat will revert to normal run mode.

D. Hold Temperature Until (Vacation Hold) - Change and hold the temperature setting until a specified date.

1. Press '**M**' button 3 times to enter the '**Hold Temp. until**' setting mode.
2. Press '+ or -' to adjust the setpoint (**Temp. Set** flashing)
3. Press **OK**. Enter the **Month** (press + or - and **OK**) and **Day** (pressing + or - & **OK** again) when this mode must terminate.
4. The display will be showing the '**Hold Temp. until**'.
5. Pressing **OK** will cancel / terminate this mode.

ERASE MEMORY BACKUP (EEPROM)

7

This operation will erase all user program settings and the thermostat will revert to it's factory settings!
Press the **OK** and - button and hold pressed in for 6 seconds.

The word "Reset" will appear in the display. Using a small pointed object, press the Reset button on the left and the user programs will be erased.

REPLACING THE BATTERIES

8

The batteries should last for about 12 months. Once the batteries are removed, the clock will keep time for about 10 seconds. In case the clock has lost it's time, use the instruction under 4. to re-enter the date and time.
The user program will be retained.